

Description of Parts

- ① Hearing Aid x 1
- ② Case x 1
- ③ Soft Tips (Large, medium, and small) x 1
- ④ Clean Brush x 1
- ⑤ PR-41(312) Battery x 2

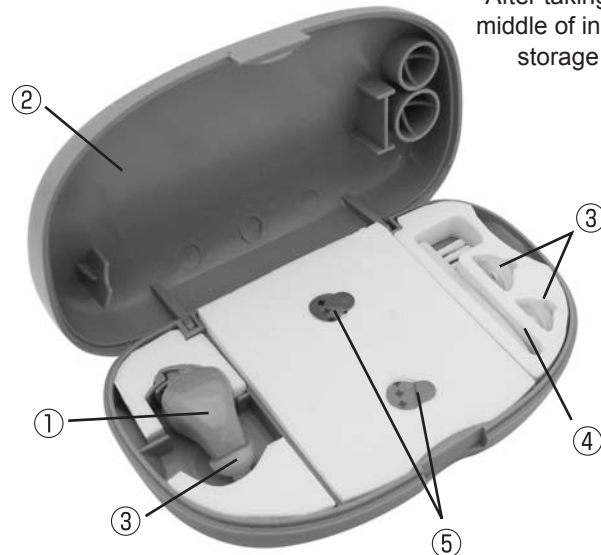

After taking out the top from the middle of inside the case, you can storage the PR-41(312) battery.



Operating Diagram

Hearing Aid:

Nozzle of soft tip:
Amplified sound travels through the nozzle and into the ear.

Soft tip:
The hearing aid comes with a choice of 3 sizes of soft tips to ensure perfect fit and comfort. You will find that the medium sized soft tip is already installed on the appliance, and the small and large soft tips can be found in the compartment on the back of the hearing aid.

Microphone : Amplifies the sound

Volume adjustment control:
Switching the hearing aid ON / OFF and adjusting the volume by using another side of cleaning brush.

Battery cap
Before using this hearing aid, you have to make sure that the PR-41 (312) battery was inserted, and the cap was complete close.

Case:



The hearing aid will be shut down automatically after you put it back and close the case.

Place the Hearing Aid



- ① Insert hearing aid into the case as shown in PIC 1.
- ② Close the case as shown in PIC 2.
- ③ the battery will stay automatically isolation as show in PIC 3.



Note: Ensure the hearing aid is correctly positioned as shown in the diagram.

Rechanging the Batteries



Open the battery cap.



Install a PR-41(312) battery into the hearing aid as shown.

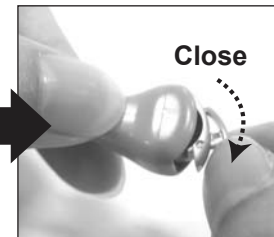

Positive terminal facing outwards, close the battery cap.

Removing the Hearing Aid from the Case

- 1. Open the lid of the case.
- 2. Pull upwards on the hearing aid until it is in the vertical position.
- 3. Remove the hearing aid from the case.
- 4. Close the battery cap

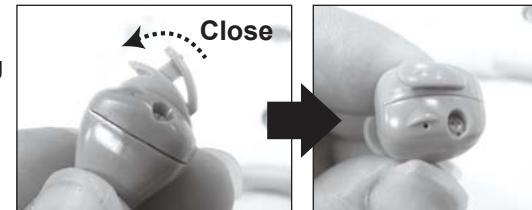

Switching the Hearing Aid ON / OFF and Adjusting the Volume

- 1. Adjusting the volume by using another side of cleaning brush.

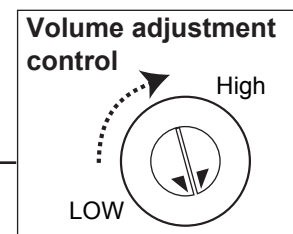
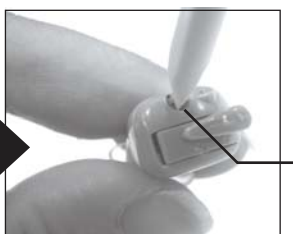

- 2. The volume will be higher when you turn the switch clockwise. And the volume will be lower when you turn the switch counterclockwise.

Usage

- 1. Turn the power on, and hold the body of the hearing aid.
- 2. Use your finger to grasp the microphone and block the hole.

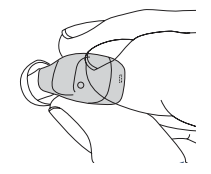
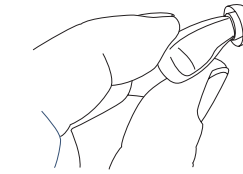

- 3. Place the hearing aid in your ear while you are grasping it.



You will hear a ringing sound if you put the hearing aid into your ear without holding the microphone.

Maintenance

- 1. **Before using the hearing aid clean your ear using cotton swabs.**
**If the nozzle of the soft tip is clogged with earwax, sound quality will be impaired.
- 2. **On a regular basis clean the hearing aid using the cleaning brush, paying particular attention to the nozzle of the soft tip where wax can collect.**

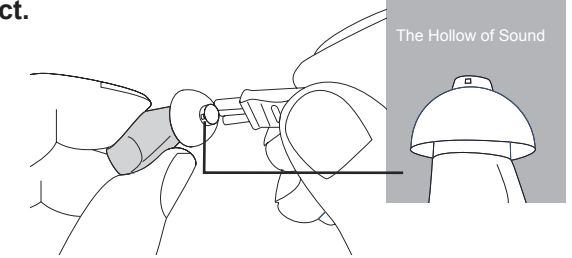

Replacing the Soft Tips

⊗ If the soft tip is damaged or wax cannot be removed from it, you will need to replace it.

- 1. Remove the old soft tip by pulling it back over the rim and removing.

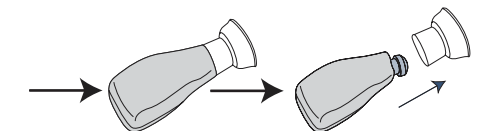

- 2. To replace the new soft tip turn it inside out so that the large opening is exposed.

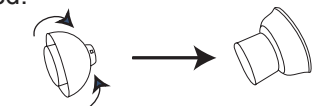

- 3. Place the soft tip onto the brim and roll it back into position as illustrated. Then return the turnover brim to the original state.

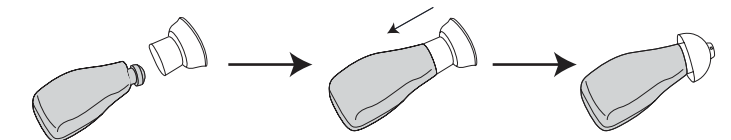

⊗ **Keep the hearing aid away from corroding gas or dust and do not expose to direct sunlight, high temperatures or humidity.**

Note: Before and After Each Use

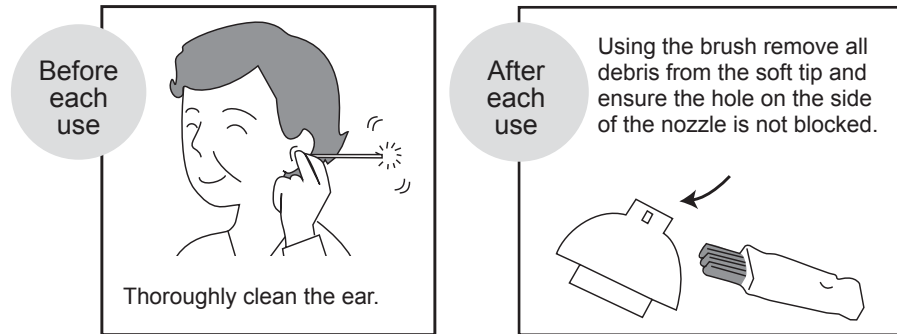

Components

Component	Item Size	Image
Hearing Aid	13.2 x 12.5 x 23.5 mm	
Case	102.8 x 59 x 23.5 mm	
Ear Cap(Large)	Consumable Parts	
Ear Cap(Medium)	Consumable Parts	
Ear Cap(Small)	Consumable Parts	

Warning

- * Follow the instructions carefully to avoid personal injury or damage to the appliance.
- * Keep the hearing aid out of reach of children.
- * To avoid injury remove the hearing aid before sleeping.
- * Remove the hearing aid before taking part in vigorous exercise to avoid damaging the hearing aid.
- * Remove the hearing aid before using a mobile phone as the radio waves will cause disturbance to the hearing aid.
- * The hearing aid must be kept dry. Do not moisten the hearing aid, or expose to hair spray. Remove before baths and showers.

Note: Please dispose of the hearing aid and batteries safely.

Before Contacting Customer Services

Before contacting customer services please examine the hearing aid and refer to the checklist below. If the hearing aid still will not work, please contact customer services.

Problem	Solutions
Cannot hear any sound	-Check that the power is on by twisting the volume adjustment control on the side of the hearing aid.
There can be a number of reasons that the hearing aid does not perform Correctly. Please refer to " solutions " .	-Check that the soft tip is not clogged with wax and remove any debris with the cleaning brush.
Please note it is also important to see a doctor periodically to check the problem is not due to hearing deterioration.	-Check if the batteries are flat, to replace with new ones.

Guarantee

Thank you for purchasing this product, which has been made to demanding high quality standards and is guaranteed for domestic use against manufacturing faults for a period of 12 months from the date of purchase.

This guarantee does not affect your statutory rights. If your product fails due to a defect in material or workmanship during this period, please return it to the place of purchase. Normal wear and tear is not covered under the guarantee.

This guarantee is invalid if the product has been misused, subject to neglect, or has been attempted to be repaired by anyone other than our own service center.

Due to continuous product improvement, we reserve the right to change the product specification without prior notice.

Please retain for future reference. Colours and contents may vary. Waste electrical products should not be disposed of with household waste. Please recycle where facilities exist. Check with your Local Authority or retailer for recycling advice.

SPECIFICATION & FUNCTION

Appliance: Hearing aid with soft tips
Purpose & Function: Enhances natural ability
Appliance Name / Item Code: Hearing Aid / UP6SY3
Standard Frequency: 2500Hz
Maximum Output Sound Level Gain: 30± 5dB
Highest Sound Pressure Level for Input SPL 90dB: 109±5dB below 125dB
Equivalent Input Noise Level: Below 29dB
Total Harmonic Distortion Value of Reality: 2500Hz: below 3%; 800Hz:below 4%; 500Hz:below 4%
Battery Current: Below 0.8mA
Battery Type / Life Expectancy: Button size PR-41(312) battery.
Continuous Use: 260 hours
Suitable : Not recommend for serious hearing loss.
Operating Temperature / Humidity: +10°C ~ +40°C, 30% ~ 85% RH
Storage Temperature / Humidity: -10°C to +60°C, 30% ~ 85% RH
Size: <Hearing aid> 13.2(L) x12.5(W) x23.5(H)mm <Case> 102.8(L) x 59(W) x23.5(H)mm
Weight: <Hearing aid> 2.2g <Case> 37.6g
Materials: <Hearing aid> ABS <Case>ABS <Soft tips> silicone